

Ground-Tite® 4Q 45° Grounding Liquidtight Connectors

NEC/CEC — Suitable for use in the following Hazardous Locations:
 Class I, Division 2 per NEC 501.10(B)(4)
 Class I, Zone 2 per NEC 505.15(C)(2)
 Class II, Division 1 per NEC 502.10(A)(2)(2)
 Class II, Division 2 per NEC 502.10(B)(2)

NEC/CEC — Suitable for use in the following Hazardous Locations:
 Class III, Division 1 per NEC 503.10(A)(3)(2)
 Class III, Division 2 per NEC 503.10(B)
 Intrinsically Safe per NEC 504.20

Applications

- Secures, grounds and seals liquidtight flexible metal conduit and terminates bonding conductor run externally alongside liquidtight conduit.

Features

- Positive grounding type.
- Tapered threaded male hub — NPT.
- Grounding lug is cast as an integral part of malleable iron gland nut. Provides high ground fault withstand capability.
- Compact, slim diameter with small turning radius.
- Furnished with locknut and KO sealing ring.
- Liquidtight/Raintight/Oiltight/Concretetight.
- UL Listed NEMA Type 4 when installed into a NPT threaded entry or UL Listed conduit hub (sizes 1-1/4" and larger require thread sealant).
- Bonding wedge locknuts are recommended in hazardous locations. See 101 Series.
- Long ferrule prevents pull-out and tight bend conduit "pop-out".
- Inspection windows in ferrule to ensure full engagement.

Standard Materials

- Malleable iron body and nut
- Steel ferrule

Standard Finishes

- Zinc electroplated

Options

- Hot dip or mechanical galvanize, add suffix **-G** to catalog number. Contact your local representative for pricing and availability.

NEC/CEC Certifications and Compliances

- UL Listed: E-24264
- CSA Certified: 9795

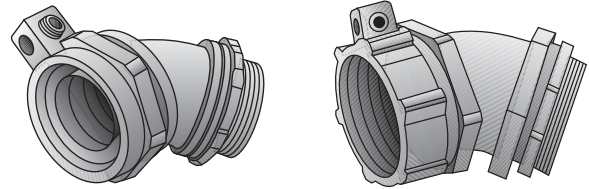

Type 4Q-438L — Type 4Q-4200L Type 4Q-4250L — Type 4Q-4500L

Illustrated Dimensions

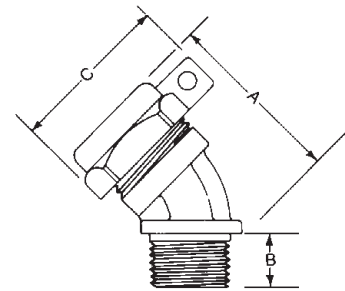

Trade Size (Inches)	Dimensions in Millimeters (Inches)			Turning Radius Gland Nut	Ground Wire Size		Catalog Number	Insulated Throat Catalog Number
	A	B	C		Min.	Max.		
3/8 (1/2 KO)	44.45 (1.75)	12.70 (0.50)	42.93 (1.69)	26.92 (1.06)	14	4	4Q-438L	4Q-438LT
1/2	44.45 (1.75)	14.22 (0.56)	47.75 (1.88)	30.23 (1.19)	14	4	4Q-450L	4Q-450LT
3/4	52.32 (2.06)	14.22 (0.56)	54.10 (2.13)	33.27 (1.31)	14	4	4Q-475L	4Q-475LT
1	84.07 (3.31)	12.70 (0.50)	60.45 (2.38)	36.58 (1.44)	14	4	4Q-4100L	4Q-4100LT
1-1/4	76.20 (3.00)	16.00 (0.63)	73.15 (2.88)	44.45 (1.75)	6	1/0	4Q-4125L	4Q-4125LT
1-1/2	79.50 (3.13)	16.00 (0.63)	82.55 (3.25)	47.75 (1.88)	6	1/0	4Q-4150L	4Q-4150LT
2	95.25 (3.75)	14.22 (0.56)	95.25 (3.75)	55.63 (2.19)	6	1/0	4Q-4200L	4Q-4200LT
2-1/2	146.05 (5.75)	25.40 (1.00)	117.60 (4.63)	69.85 (2.75)	1	4/0	4Q-4250L	4Q-4250LT
3	165.10 (6.50)	28.70 (1.13)	134.87 (5.31)	77.72 (3.06)	1	4/0	4Q-4300L	4Q-4300LT
4	190.50 (7.50)	30.23 (1.19)	165.10 (6.50)	92.20 (3.63)	1	4/0	4Q-4400L	4Q-4400LT
5	203.20 (8.00)	31.75 (1.25)	190.50 (7.50)	106.43 (4.19)	1	4/0	4Q-4500L ①	4Q-4500LT ①

① UL Listing not applicable.